

BRUCEVILLE POINT

A *tenfold* Senior Living Community

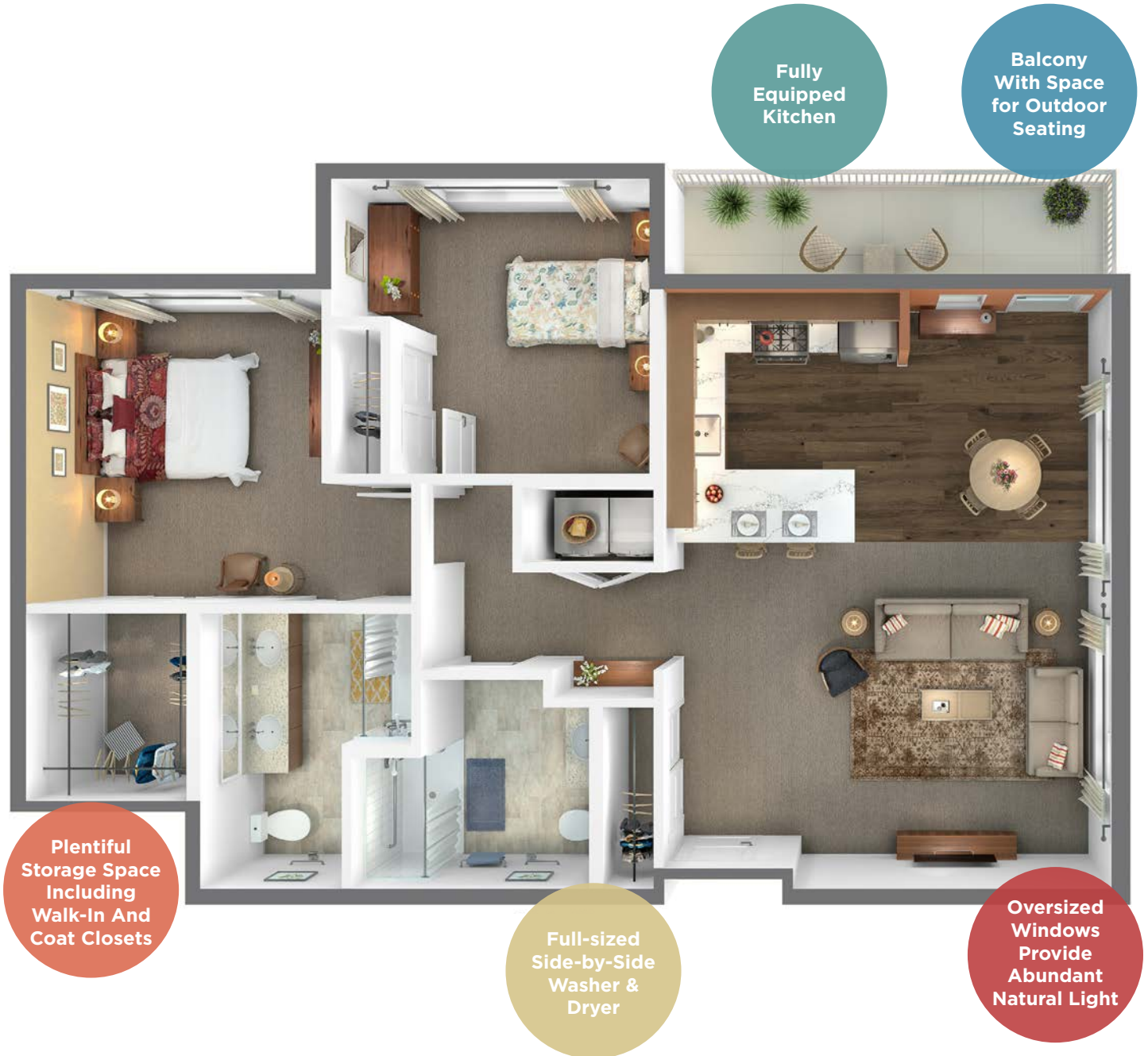

TWO BEDROOM/TWO BATH PREMIUM (C2)

1184 SQUARE FEET

LIVING/DINING AREA: 18'-3" X 14'-0"

BEDROOM: 12'-0" X 12'-9"

WALK-IN CLOSET: 6'-6" X 7'-8"

COAT CLOSET: 8 LINEAR FT



9730 Backer Ranch Road, Elk Grove, CA 95757 • 916-226-5300 • info@brucevillepoint.com