

BRUCEVILLE POINT

A *tenfold* Senior Living Community

Oversized
Windows
Provide
Abundant
Natural Light

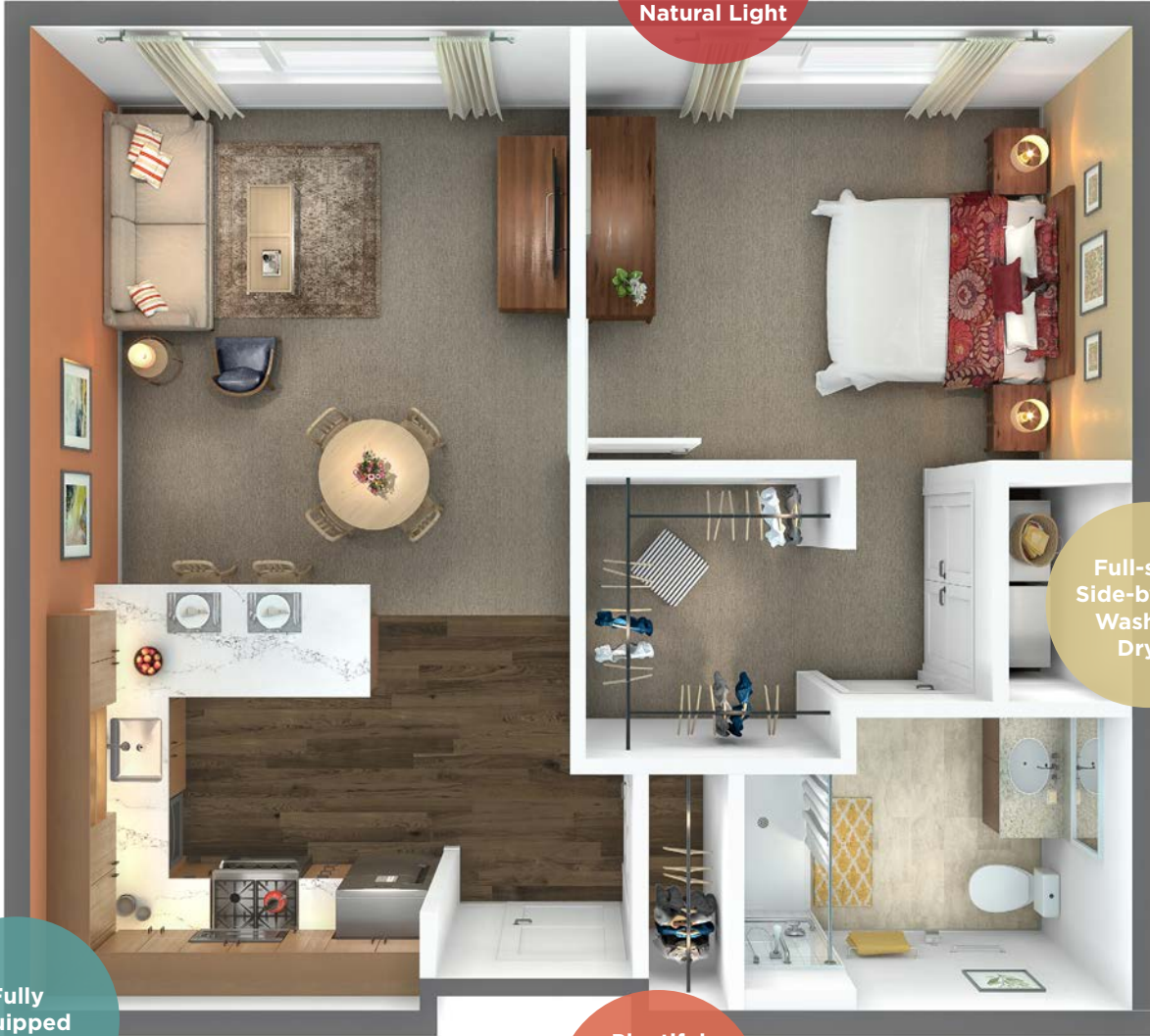

Full-sized
Side-by-Side
Washer &
Dryer

Fully
Equipped
Kitchen

Plentiful
Storage Space
Including
Walk-In And
Coat Closets

ONE BEDROOM DELUXE (B1)

709 SQUARE FEET

LIVING/DINING AREA: 13'-6" X 14'-1"

BEDROOM: 13'-6" X 10'-9"

WALK-IN CLOSET: 6'-4" X 7'-0"

COAT CLOSET: 6 LINEAR FT



9730 Backer Ranch Road, Elk Grove, CA 95757 • 916-226-5300 • info@brucevillepoint.com